

GVM57AT

Energy-optimized Tropical Compressor

R134a

220-240V 50Hz

General

| | |
|-----------------------|-----------------------------|
| Code number | 102A4903 |
| Approvals | EN 60335-2-34 with Annex AA |
| Compressors on pallet | 125 |

Application

| | | |
|------------------------------------------------|-----|-------------------|
| Application | LBP | |
| Frequency | Hz | 50 60 |
| Evaporating temperature | °C | -35 to -10 - |
| Voltage range | V | 187 - 254 - |
| Max. condensing temperature continuous (short) | °C | 60 (70) - |
| Max. winding temperature continuous (short) | °C | 125 (135) - |

Cooling requirements

| | | | | | | | |
|-------------------------|----|-----|-----|-----|-----|-----|-----|
| Frequency | Hz | 50 | | | 60 | | |
| Application | | LBP | MBP | HBP | LBP | MBP | HBP |
| 32°C | | S | - | - | - | - | - |
| 38°C | | S | - | - | - | - | - |
| 43°C | | S | - | - | - | - | - |
| Remarks on application: | | | | | | | |

Motor

| | | |
|-------------------------------------------|----------------|----------------|
| Motor type | RSIR/RSCR/CSIR | |
| LRA (rated after 4 sec. UL984), HST LST | A | 5.9 5.5 |
| Cut in Current, HST LST | A | 5.9 10.1 |
| Resistance, main start winding (25°C) | Ω | 13.2 14.8 |

Design

| | | |
|-------------------------------------|-----------------|-------------------|
| Displacement | cm ³ | 5.70 |
| Oil quantity (type) | cm ³ | 180 (polyolester) |
| Maximum refrigerant charge | g | 400 |
| Free gas volume in compressor | cm ³ | 1790 |
| Weight without electrical equipment | kg | 7.5 |

Dimensions

| | | | |
|----------------------|--------------------------|---------------------------|-------------|
| Height | mm | A | 173 |
| | | B | 169 |
| | | B1 | - |
| | | B2 | - |
| Suction connector | location/I.D. mm angle | C | 6.2 30° |
| | material comment | Copper Rubber plug | |
| Process connector | location/I.D. mm angle | D | 6.2 31.5° |
| | material comment | Copper Rubber plug | |
| Discharge connector | location/I.D. mm angle | E | 5.0 28° |
| | material comment | Copper Rubber plug | |
| Oil cooler connector | location/I.D. mm angle | F | - |
| | material comment | - | |
| Connector tolerance | I.D. mm | ±0.09, on 5.0 +0.12/+0.20 | |
| Remarks: | | | |

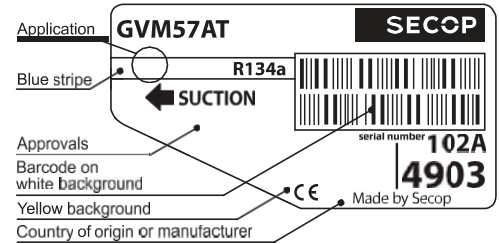

- S = Static cooling normally sufficient
- O = Oil cooling
- F₁ = Fan cooling 1.5 m/s (compressor compartment temperature equal to ambient temperature)
- F₂ = Fan cooling 3.0 m/s necessary
- SG = Suction gas cooling normally sufficient
- = not applicable in this area

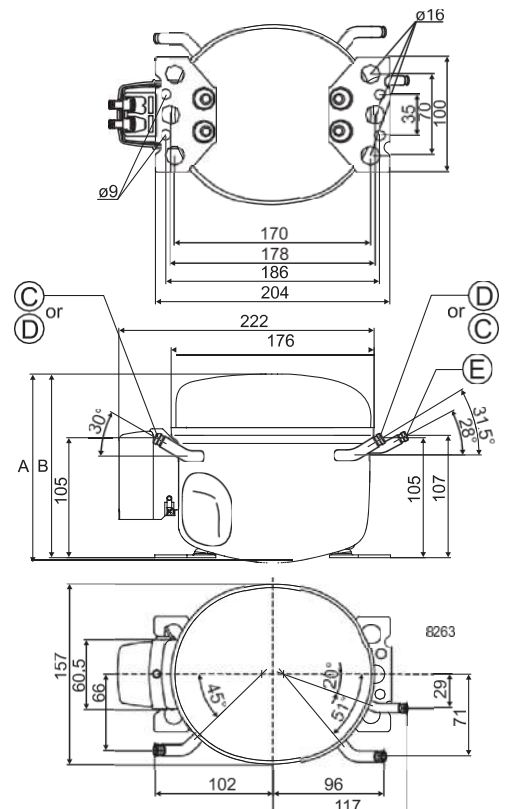

EN 12900 Household (CECOMAF) 220V, 50Hz, 2 W PTC consumption incl., static cooling

| | | | | | | | | | | | | | | | | | |
|--------------------|-----|-----|------|------|------|-------|------|------|------|------|----|---|---|-----|----|----|----|
| Evap. temp in °C | -45 | -40 | -35 | -30 | -25 | -23.3 | -20 | -15 | -10 | -6.7 | -5 | 0 | 5 | 7.2 | 10 | 15 | 20 |
| Capacity in W | | | 66.3 | 90.3 | 120 | 132 | 156 | 200 | 253 | | | | | | | | |
| Power cons. in W | | | 90.0 | 105 | 120 | 125 | 136 | 152 | 170 | | | | | | | | |
| Current cons. in A | | | 0.89 | 0.92 | 0.96 | 0.97 | 1.00 | 1.06 | 1.13 | | | | | | | | |
| COP in W/W | | | 0.74 | 0.86 | 1.00 | 1.05 | 1.15 | 1.32 | 1.48 | | | | | | | | |

EN 12900 Household (CECOMAF) 220V, 50Hz, RC 4µF, 2 W PTC consumption incl., static cooling

| | | | | | | | | | | | | | | | | | |
|--------------------|-----|-----|------|------|------|-------|------|------|------|------|----|---|---|-----|----|----|----|
| Evap. temp in °C | -45 | -40 | -35 | -30 | -25 | -23.3 | -20 | -15 | -10 | -6.7 | -5 | 0 | 5 | 7.2 | 10 | 15 | 20 |
| Capacity in W | | | 66.3 | 90.3 | 120 | 132 | 156 | 200 | 253 | | | | | | | | |
| Power cons. in W | | | 87.6 | 101 | 115 | 120 | 130 | 146 | 163 | | | | | | | | |
| Current cons. in A | | | 0.61 | 0.65 | 0.70 | 0.71 | 0.75 | 0.82 | 0.89 | | | | | | | | |
| COP in W/W | | | 0.76 | 0.89 | 1.04 | 1.09 | 1.20 | 1.37 | 1.55 | | | | | | | | |

ASHRAE LBP 220V, 50Hz, 2 W PTC consumption incl., static cooling

| | | | | | | | | | | | | | | | | | |
|--------------------|-----|-----|------|------|------|-------|------|------|------|------|----|---|---|-----|----|----|----|
| Evap. temp in °C | -45 | -40 | -35 | -30 | -25 | -23.3 | -20 | -15 | -10 | -6.7 | -5 | 0 | 5 | 7.2 | 10 | 15 | 20 |
| Capacity in W | | | 82.3 | 112 | 149 | 163 | 194 | 248 | 314 | | | | | | | | |
| Power cons. in W | | | 90.1 | 105 | 120 | 125 | 135 | 152 | 170 | | | | | | | | |
| Current cons. in A | | | 0.89 | 0.92 | 0.96 | 0.97 | 1.00 | 1.06 | 1.12 | | | | | | | | |
| COP in W/W | | | 0.91 | 1.07 | 1.24 | 1.31 | 1.43 | 1.64 | 1.85 | | | | | | | | |

ASHRAE LBP 220V, 50Hz, RC 4µF, 2 W PTC consumption incl., static cooling

| | | | | | | | | | | | | | | | | | |
|--------------------|-----|-----|------|------|------|-------|------|------|------|------|----|---|---|-----|----|----|----|
| Evap. temp in °C | -45 | -40 | -35 | -30 | -25 | -23.3 | -20 | -15 | -10 | -6.7 | -5 | 0 | 5 | 7.2 | 10 | 15 | 20 |
| Capacity in W | | | 82.3 | 112 | 149 | 163 | 194 | 248 | 314 | | | | | | | | |
| Power cons. in W | | | 87.8 | 101 | 115 | 120 | 130 | 145 | 162 | | | | | | | | |
| Current cons. in A | | | 0.61 | 0.65 | 0.69 | 0.71 | 0.75 | 0.81 | 0.89 | | | | | | | | |
| COP in W/W | | | 0.94 | 1.10 | 1.29 | 1.36 | 1.49 | 1.71 | 1.94 | | | | | | | | |

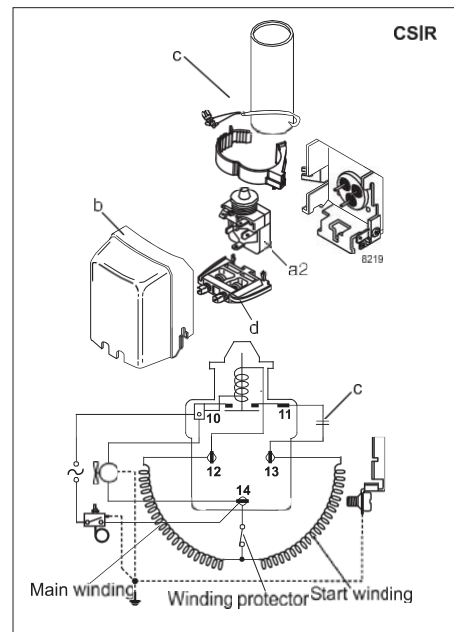
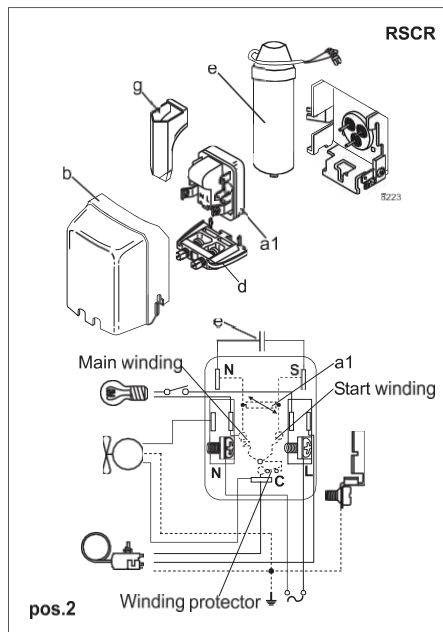
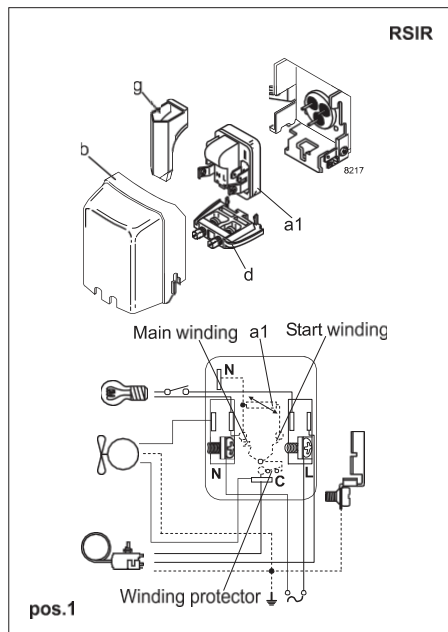

| Accessories for | GVM57AT | Figure | Code number | Test conditions | EN 12900/CECOMAF | ASHRAE |
|---------------------------|-------------------------|-----------------------|-------------|-----------------------------|------------------|--------------------|
| PTC starting device | 6.3 mm spade connectors | a1 (pos. 1) | 103N0011 | Condensing temperature | 55°C | 54.4°C |
| | 4.8 mm spade connectors | | 103N0018 | Ambient temperature | 32°C | 32°C |
| PTC starting device | 6.3 mm spade connectors | a1 (pos. 2) | 103N0016 | Suction gas temperature | 32°C | 32°C |
| | 4.8 mm spade connectors | | 103N0021 | Liquid temperature | no subcooling | 32°C |
| Starting relay | 6.3 mm spade connectors | a2 | 117U6004 | | | |
| Start capacitor 60 µF | 6.3 mm spade connectors | c | 117U5014 | | | |
| Cover | | b | 103N2010 | | | |
| Cord relief | | d | 103N1010 | | | |
| Run capacitor | 6.3 mm spade connectors | e | 117-7117 | | | |
| 4 µF (optional) | 4.8 mm spade connectors | | 117-7119 | | | |
| Protection screen for PTC | | g | 103N0476 | | | |
| | | | | Mounting accessories | | Code number |
| | | | | Bolt joint for one comp. | Ø: 16 mm | 118-1917 |
| | | | | Bolt joint in quantities | Ø: 16 mm | 118-1918 |
| | | | | Snap-on in quantities | Ø: 16 mm | 118-1919 |

Secop can accept no responsibility for possible errors in catalogues, brochures and other printed material. Secop reserves the right to alter its products without notice. This also applies to products already on order provided that such alterations can be made without consequential changes being necessary in specifications already agreed. All trademarks in this material are property of the respective companies. Secop and the Secop logotype are trademarks of Secop GmbH. All rights reserved. www.secop.com